

# EXTREME ENVIRONMENT

## SMD HIGH-TEMPERATURE CRYSTAL OSCILLATORS

### FMOCHT5S SERIES

Extreme Temperature  
Crystal Oscillators

CERAMIC SMD 5x7

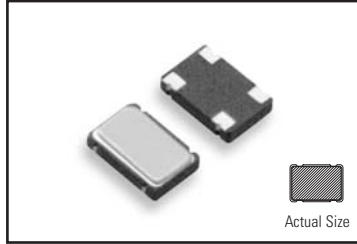

- 32.768 kHz to 64 MHz
- 3 to 6 Volts
- High-Shock & Vibration
- -70°C to +210°C

### SPECIFICATIONS

05 | ISSUES | 092805

Parameter	Specification
Frequency Range	32.768 kHz to 64 MHz
Operating Temperature Range	-70°C to +210°C, Customer Specified
Overall Frequency Tolerance vs. Temperature	±100ppm, ±150ppm, ±175ppm, ±250ppm Customer Specified   Temperature Dependent example: ±250ppm; -40°C to +200°C example: ±100ppm; 0°C to +200°C
Storage Temperature	-70°C to +235°C
Supply Voltage	3.3V, 5V (all ± 10%) Optional: Lower Voltages (options may vary w/ temp. &/or frequency)
Supply Current	See table below
Rise and Fall Time	3 ns Typical
Start Time	10 ms max. < 5 ms typical
Output	CMOS, (SOI Option, please inquire)
Output Enable Options	Enabled on Logic "1" (available for temperatures up to +210°C)
Screening & Testing to MIL-PRF-55310	Available

All specifications subject to change without notice.

#### CERAMIC SMD

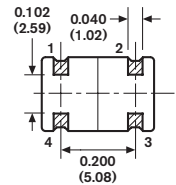
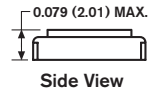
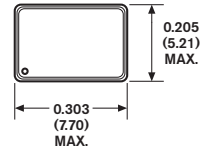

#### Bottom View

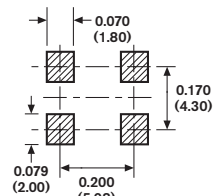

#### Recommended Land Pattern

Dimensions: Inches  
(mm)

#### PACKAGE OPTIONS

- 4 Pad
- 6 Pad
- 4 Pad with Gullwing Leads

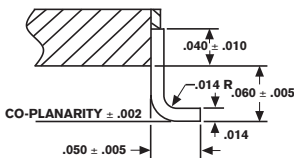

JEDEC TYPE MO-111  
"GULLWING" FORM

#### SUPPLY CURRENT

Voltage	Frequency		
	32.768 kHz	16 MHz	64 MHz
3.3V	.45mA (typ)	4mA (typ)	14mA (typ)
5.0V	1mA (typ)	8mA (typ)	26mA (typ)

#### PIN FUNCTION TABLE

Pad	Function
1	NC or Tri-state
2	Ground (Case)
3	Output
4	Supply Voltage (Vcc)

PLEASE CONTACT US FOR ADDITIONAL PRODUCT SPECIFICATIONS & OR YOUR CUSTOM REQUIREMENTS